

FORM No. 1.

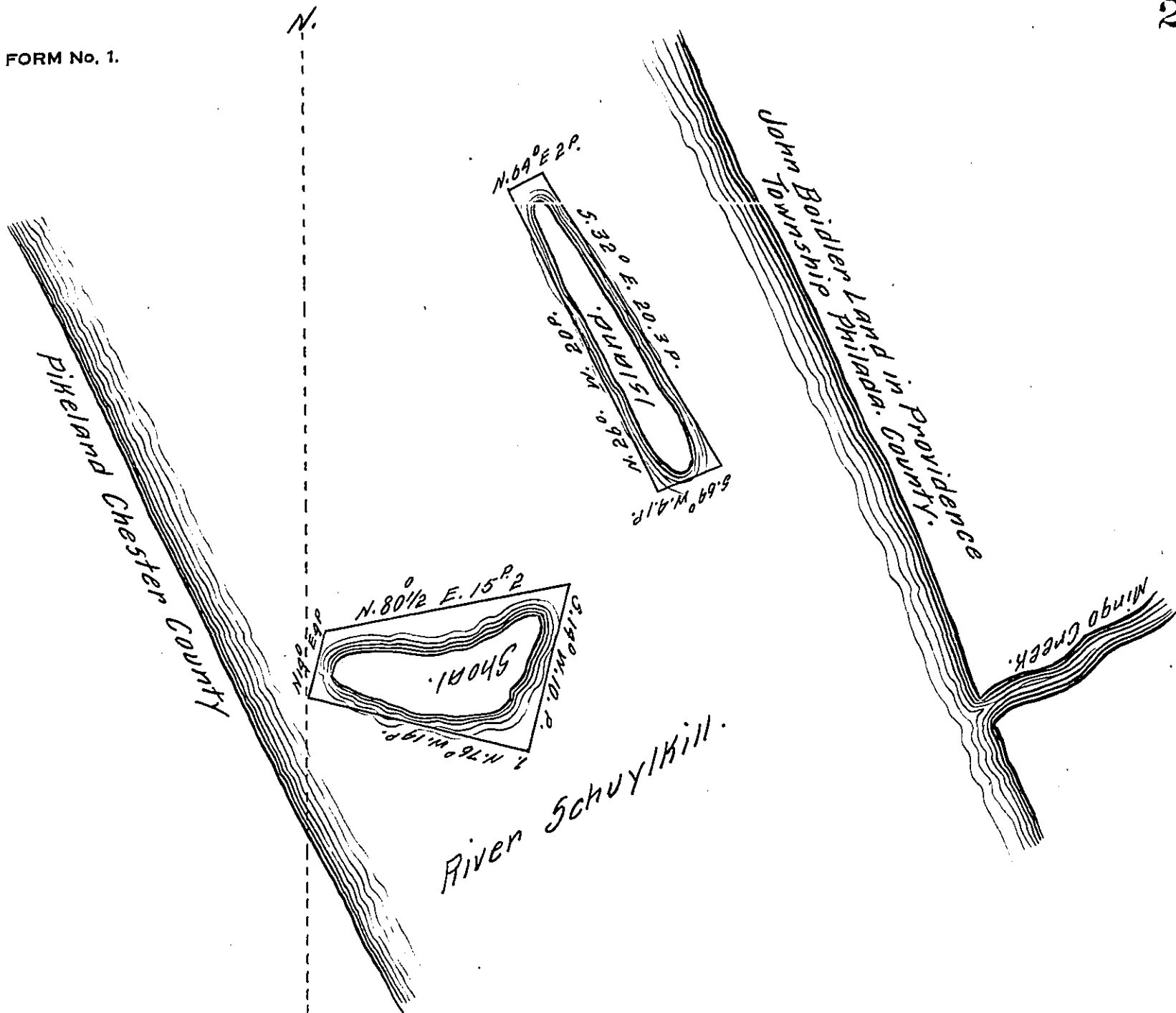

To John Lukens Esqr. Surveyor General.
 Pursuant to thy deputation I have surveyed the above de-
 scribed Island and Shoal for John Boidler in Right of
 Samuel Bell, the Island with Gravel round it I find contains
 60 Perches & 3 tenths strict Measure the Shoal 98 P. like
 Measure.

The Island is the next above the mouth of Mingo Creek in
 the River Schuylkill & the Shoal opposite to the Island as
 appears by the Draughts.

Survey'd May 6th. 1784.

By Aaron Roberts.

IN TESTIMONY that the above is a copy of the original remaining on file in
 the Department of Internal Affairs of Pennsylvania, made
 conformably to an Act of Assembly approved the 16th day of
 February, 1833, I have hereunto set my Hand and caused
 the Seal of said Department to be affixed at Harrisburg,
 this twenty third day of May 1910

Aaron Houch
 Secretary of Internal Affairs.